

The square footages and room size information are deemed to be reliable but are not guaranteed and should be independently verified.

# 7173 N Cathedral Rock Pl

Presented by Sherie Broekema, ABR, CRS  
 Long Realty Company  
 (520) 918-5462

Main House 4,083 Sq Ft  
 Guest House 487 Sq Ft  

---

 Total Living Area 4,570 Sq Ft  
 Garage 1,112 Sq Ft

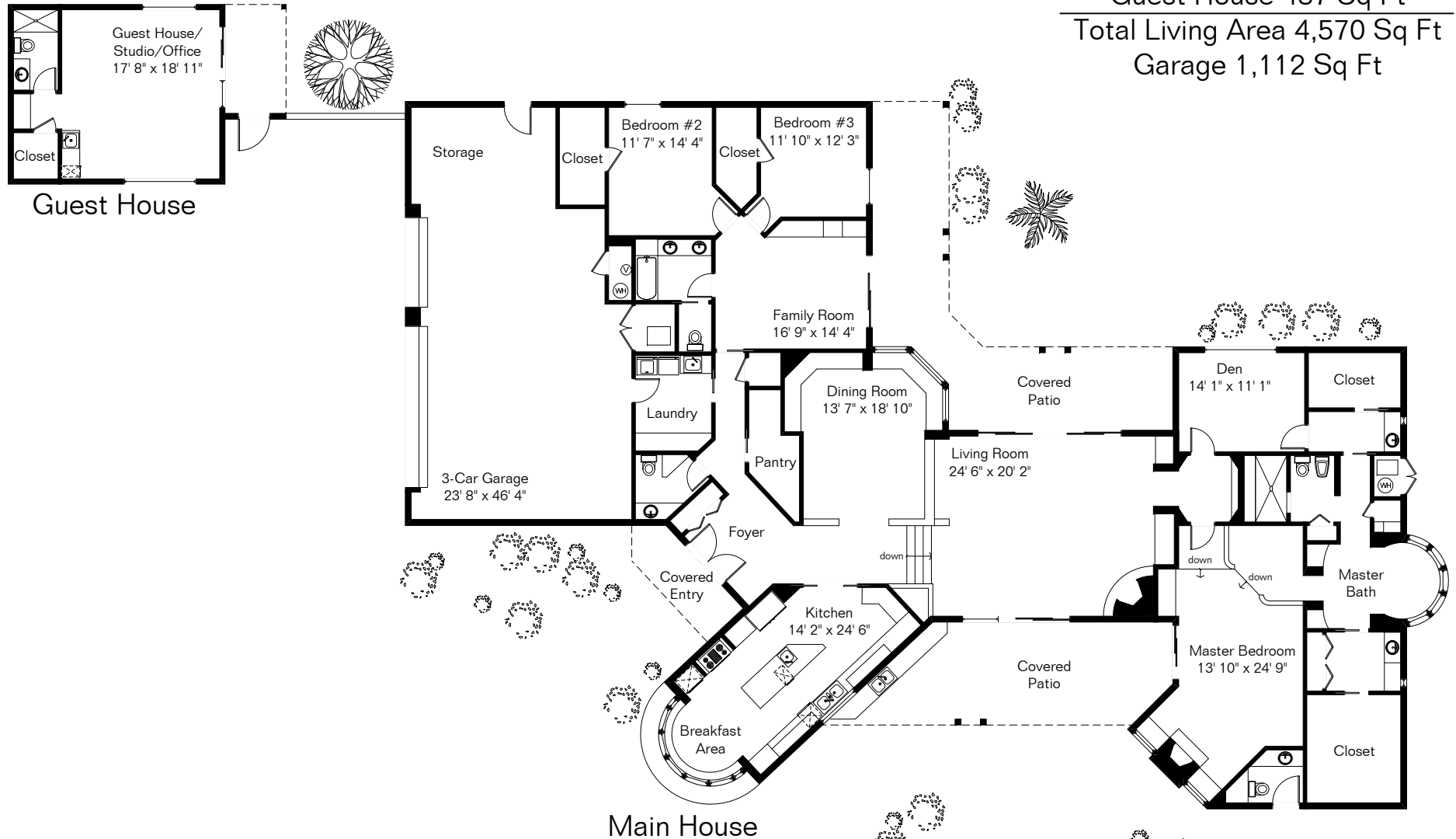

Site Visit June 2009



Copyright 2009 Floor Plans First! LLC  
 All Rights Reserved.

Pool Area

[www.FloorPlansFirst.com](http://www.FloorPlansFirst.com)

Toll Free (877) 887-1500  
 Voice (520) 881-1500  
 Fax (520) 791-7701

**Floor Plans First!**  
 See the Floor Plan First!